

SPACE FOR LEASE

Controlled Environment



with office and warehouse space if needed

Coy Laboratory Products
14500 Coy Drive
Grass Lake, MI
(734) 475-2200
Ask for Karen Studer-Rabeler

Newly retrofitted space is available due to production contract not being finalized. The area is ideally suited for providing controlled conditions for storage, assembly or manufacturing. The clean room is designed to exceed ISO Class 9 standards and will likely meet Class 8 or higher when tested.

Small company landlord will consider custom alterations for an extended lease.

Easy access:

- immediately next to I-94 (exit 153)
- in Jackson County less than 1 mile from Washtenaw County

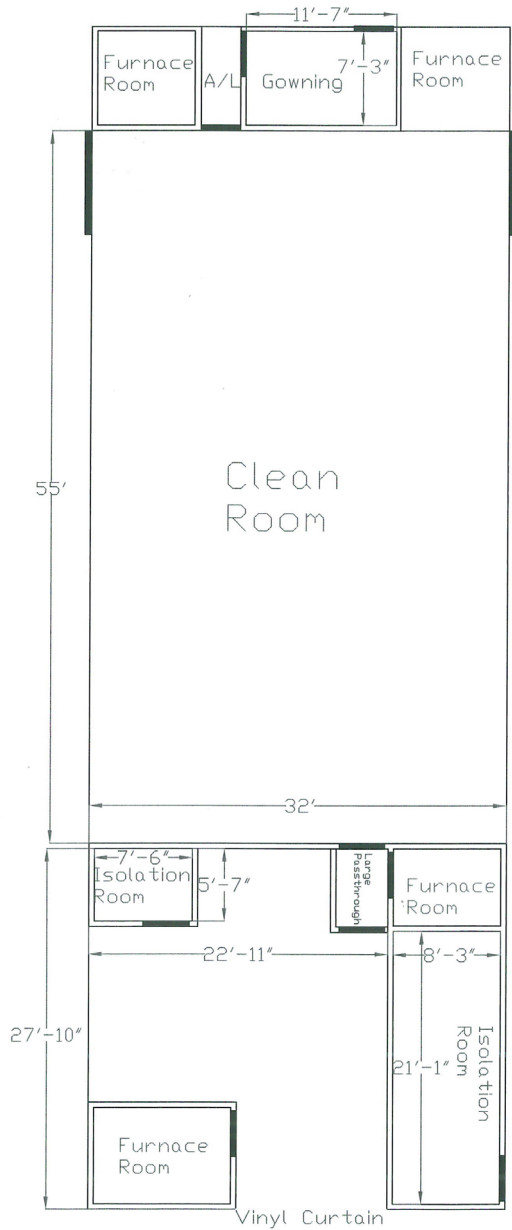

Approx 2000 sq ft available:

- electrical conduit in place (3-phase 480V & 220V)
- pneumatic installed
- HVAC to accommodate chemical or biological hoods

Located at exit 153 off of I-94

